

NOTE: BREAK ALL CORNERS WITH 0.015" (.38 MM) RADIUS UNLESS OTHERWISE NOTED. STANDARD TOLERANCES TO APPLY UNLESS OTHERWISE SPECIFIED.

CUSTOMER <h1 style="text-align: center; margin: 0;">CAN ART OPEN</h1>	DIE No. <h1 style="text-align: center; margin: 0;">ES22251</h1>	REV. No. <h1 style="text-align: center; margin: 0;">3</h1>
DESCRIPTION	CUSTOMER PART No.	QUOTE No. 23-0700-1-R-3
		PROPOSAL No. S-45739

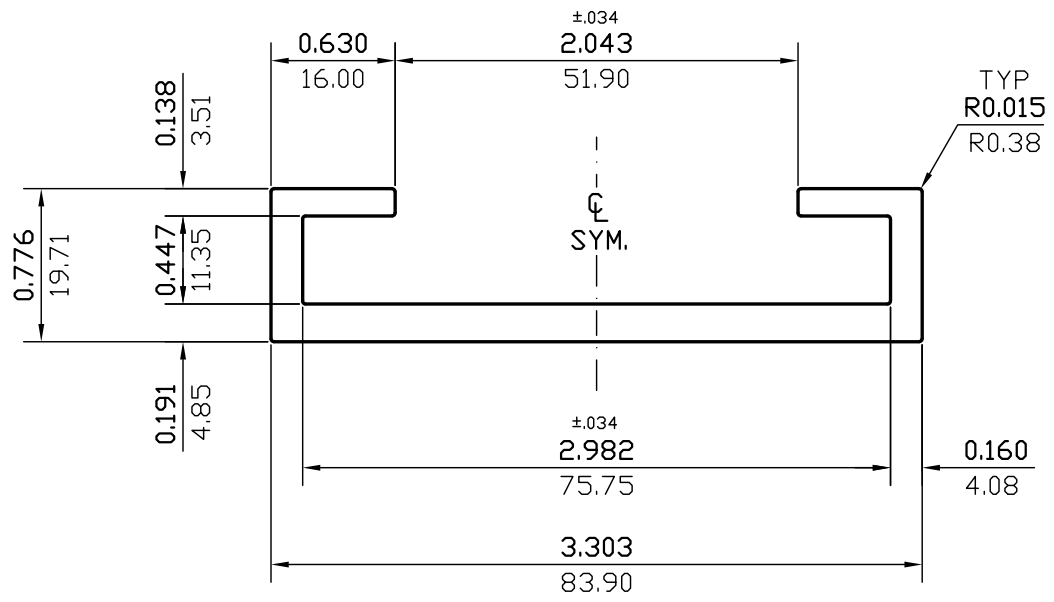

NO EXPOSED SURFACES

SHADOW LINES CAN BE EXPECTED
(***) = IN THESE AREAS AND WILL NOT
FORM THE BASIS FOR REJECTION

WALL THICKNESS **0.160 (4.06)** EXCEPT AS SHOWN

DATE	REV	DESCRIPTION	BY
05/04/26	3	BACK TO THE ORIGINAL VERSION	JASON
08/01/24	2	INCREASE GAP FROM 2.982" TO 3.303"	JASON
EST.AREA	0.948	IN. ²	EST.AREA 611.582 MM. ²
EST.WT.	1.119	LBS./FT.	EST.WT. 1.665 KG/M.
EST.PER.	11.128	IN.	EST.PER. 282.655 MM.
OUT PER.		IN.	OUT PER. MM.
C.C.D.	3.387	IN.	C.C.D. 86.028 MM.
FINISH	M/F		ALLOY 6061
CKD BY	FACTOR 10	SCALE 1:1	DWN BY J.S. DATE 11/28/2023

CAN ART

ALUMINUM EXTRUSION

85 PARKSHORE DRIVE
BRAMPTON, ONT L6T 5M1
TEL. NO. (905) 791-1464
FAX NO. (905) 791-9151
WEB: www.canart.com

THIS DRAWING IS NOT NECESSARILY A COPY OF YOUR ORIGINAL. PLEASE APPROVE DIMENSIONS AND TOLERANCES INDICATED. CAN ART ASSUMES NO RESPONSIBILITY EITHER TECHNICAL OR LEGAL FOR HAVING THIS SHAPE MADE. THE CUSTOMER AGREES TO FULLY PROTECT CAN ART ALUMINUM FROM CLAIMS OF OTHERS RESULTING FROM THIS SHAPE.

SIGNED: _____ DATE: _____