

NOTE: BREAK ALL CORNERS WITH 0.015" (.38 MM) RADIUS UNLESS OTHERWISE NOTED. STANDARD TOLERANCES TO APPLY UNLESS OTHERWISE SPECIFIED.

CUSTOMER <b>CAN ART ALUMINUM STANDARD</b>		DIE No. <b>ES04051</b>	REV. No. <b>1</b>
DESCRIPTION <b>4.0 x 2.0 x 0.150 CHANNEL</b>	CUSTOMER PART No.	QUOTE No. <b>L17-0385-2</b>	PROPOSAL No. <b>S-69455</b>

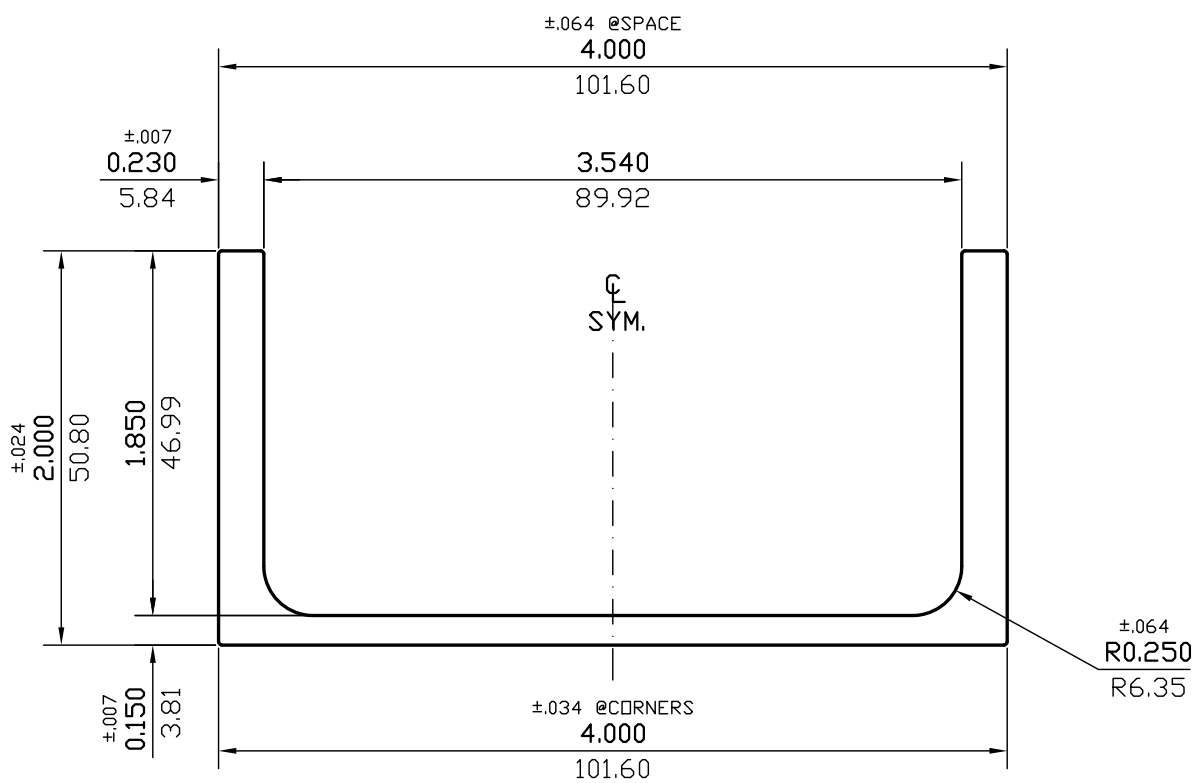

UNMARKED RAD.= R0.016(R0.41)

WALL THICKNESS (AS SHOWN) EXCEPT AS SHOWN

DATE	REV	DESCRIPTION	BY
03/21/23	1	REMOVED ALLDY	JASON
EST.AREA	1.477	IN. <sup>2</sup>	EST.AREA 953.229
			MM. <sup>2</sup>
EST.WT.	1.773	LBS/FT.	EST.WT. 2.639
			KG/M.
EST.PER.	15.444	IN.	EST.PER. 392.283
			MM.
OUT PER.		IN.	OUT PER.
			MM.
C.C.D.	4.461	IN.	C.C.D. 113.315
			MM.
FINISH	M/F		ALLOY
CKD BY	FACTOR 9	SCALE 1:1	DWN BY G.W. DATE 09/15/2017

# CAN ART

428 JUTRAS DRIVE S.  
WINDSOR, ON N8N 5C5  
TEL. NO. (519) 727-4399  
FAX NO. (519) 727-6434  
WEB: www.canart.com

ALUMINUM EXTRUSION L.P.

THIS DRAWING IS NOT NECESSARILY A COPY OF YOUR ORIGINAL. PLEASE APPROVE DIMENSIONS AND TOLERANCES INDICATED. CAN ART ASSUMES NO RESPONSIBILITY EITHER TECHNICAL OR LEGAL FOR HAVING THIS SHAPE MADE. THE CUSTOMER AGREES TO FULLY PROTECT CAN ART ALUMINUM FROM CLAIMS OF OTHERS RESULTING FROM THIS SHAPE.

SIGNED: \_\_\_\_\_ DATE: \_\_\_\_\_