

CUSTOMER PART No.

CUSTOMER

CAN ART STD.

DIE No.

ES05435

DESCRIPTION

4" x 2" x 0.125" THK. CHANNEL

PROPOSAL No.

S-3403

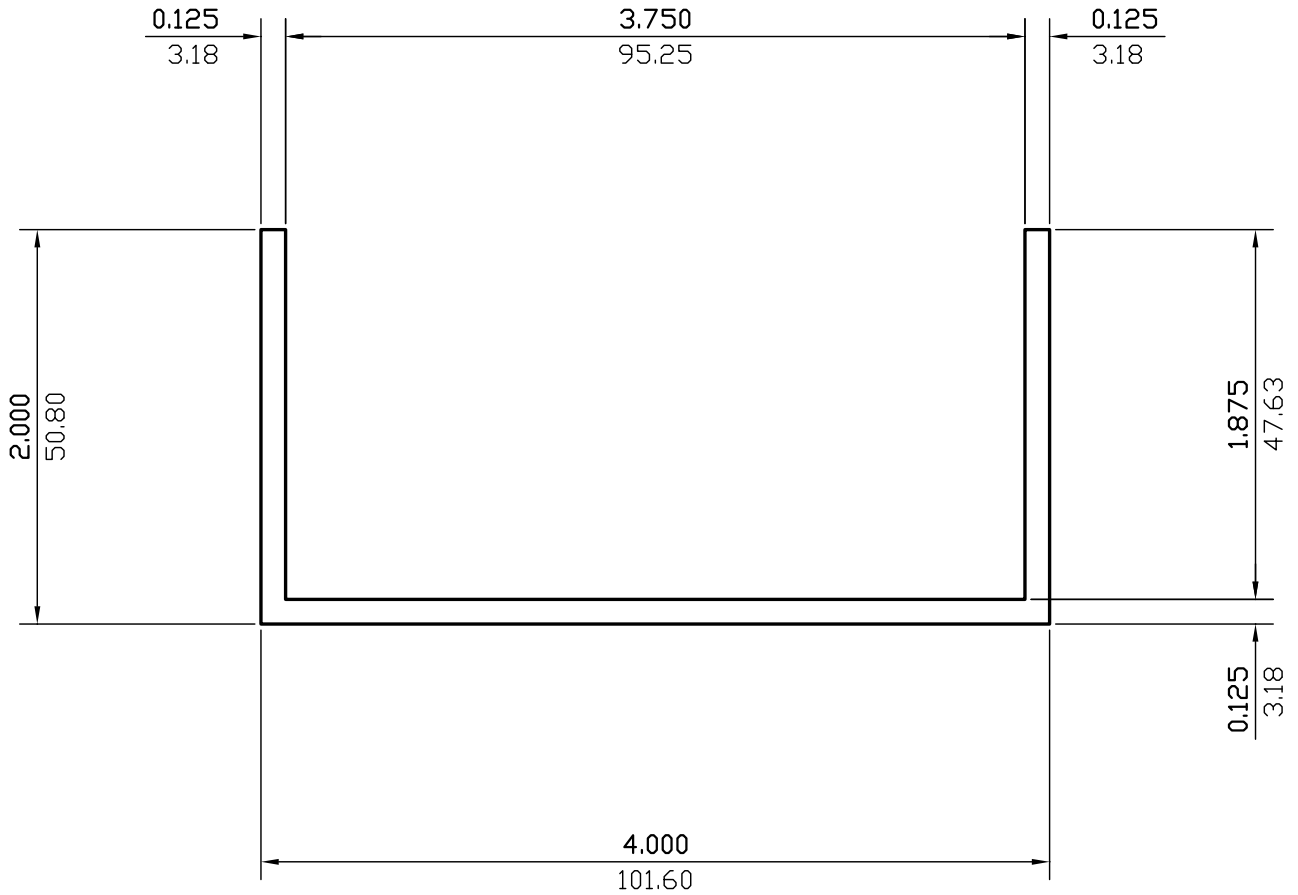

NOTE: BREAK ALL CORNERS WITH 0.015" (.38 MM) RADIUS UNLESS OTHERWISE NOTED. STANDARD TOLERANCES TO APPLY UNLESS OTHERWISE SPECIFIED.

WALL THICKNESS 0.125 (3.18) EXCEPT AS SHOWN

DATE	REV	DESCRIPTION	BY		
03/21/23	2	REMOVED ALLOY	JASDN		
08/23/99	1	REDRAWN	P.M.		
EST.AREA	0.969	IN. ²	EST.AREA	625	MM. ²
EST.WT.	1.143	LBS/FT.	EST.WT.	1.701	KG/M.
EST.PER.	15.750	IN.	EST.PER.	400.1	MM.
OUT PER.		IN.	OUT PER.		MM.
C.C.D.	4.472	IN.	C.C.D.	114	MM.
FACTOR	14	FINISH	M/F	ALLOY & TEMP.	
CKD BY		SCALE	1:1	DWN BY	C.P.
				DATE	12/08/93

CAN ART

ALUMINUM EXTRUSION INC.

85 PARKSHORE DRIVE
BRAMPTON, ONT L6T 5M1
TEL. NO. (905) 791-1464
FAX NO. (905) 791-9151
E-MAIL: canart@canart.com

THIS DRAWING IS NOT NECESSARILY A COPY OF YOUR ORIGINAL. PLEASE APPROVE DIMENSIONS AND TOLERANCES INDICATED. CAN ART ASSUMES NO RESPONSIBILITY EITHER TECHNICAL OR LEGAL FOR HAVING THIS SHAPE MADE. THE CUSTOMER AGREES TO FULLY PROTECT CAN ART ALUMINUM FROM CLAIMS OF OTHERS RESULTING FROM THIS SHAPE.

SIGNED: _____ DATE: _____