

CUSTOMER PART No.

CUSTOMER

**CAN ART STD.**

DIE No.

ES05771

DESCRIPTION

3.000 x 1.000 x 0.125 CHANNEL

PROPOSAL No.

S-12723

NOTE: BREAK ALL CORNERS WITH 0.015" (.38 MM) RADIUS UNLESS OTHERWISE NOTED. STANDARD TOLERANCES TO APPLY UNLESS OTHERWISE SPECIFIED.

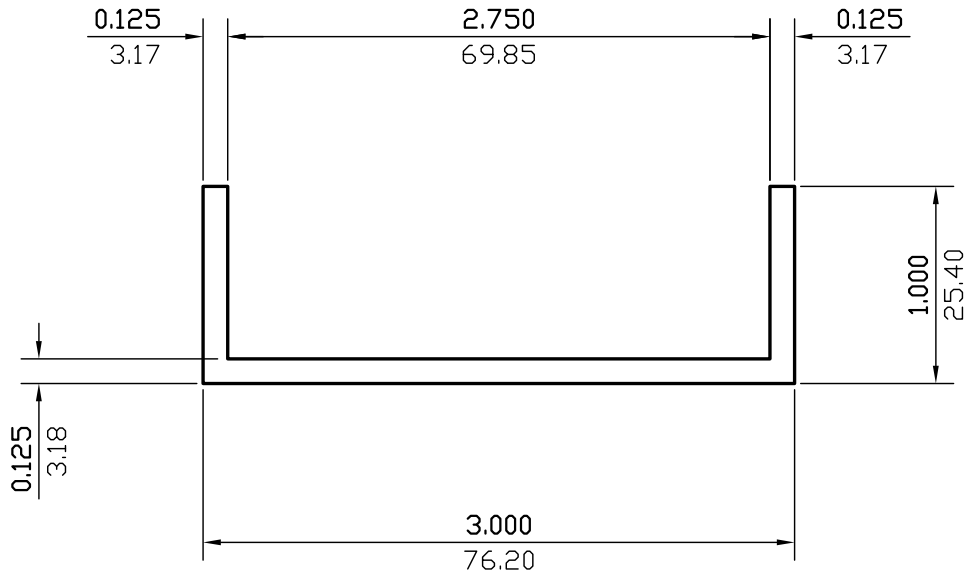

WALL THICKNESS 0.125 (3.18) EXCEPT AS SHOWN

DATE	REV	DESCRIPTION	BY
03/21/23	1	REMOVED ALLOY	JASON
EST.AREA	0.594	IN. <sup>2</sup>	EST.AREA 383.067
			MM. <sup>2</sup>
EST.WT.	0.701	LBS/FT.	EST.WT. 1.043
			KG/M.
EST.PER.	9.750	IN.	EST.PER. 247.650
			MM.
OUT PER.		IN.	OUT PER.
			MM.
C.C.D.	3.162	IN.	C.C.D. 80.322
			MM.
FACTOR	14	FINISH	M/F
		ALLOY & TEMP.	
CKD BY	SCALE 1:1	DWN BY	P.M. DATE 09/09/2002

**CAN ART**

ALUMINUM EXTRUSION INC.

85 PARKSHORE DRIVE  
BRAMPTON, ONT L6T 5M1  
TEL. NO. (905) 791-1464  
FAX NO. (905) 791-9151  
E-MAIL: canart@canart.com

THIS DRAWING IS NOT NECESSARILY A COPY OF YOUR ORIGINAL. PLEASE APPROVE DIMENSIONS AND TOLERANCES INDICATED. CAN ART ASSUMES NO RESPONSIBILITY EITHER TECHNICAL OR LEGAL FOR HAVING THIS SHAPE MADE. THE CUSTOMER AGREES TO FULLY PROTECT CAN ART ALUMINUM FROM CLAIMS OF OTHERS RESULTING FROM THIS SHAPE.

SIGNED: \_\_\_\_\_ DATE: \_\_\_\_\_