

CUSTOMER PART No.

CUSTOMER

CAN ART STD.

DIE No.

ES05190

DESCRIPTION

5/8" x 1/2" x 0.062" THK. CHANNEL

PROPOSAL No.

R0.010 I.D. MARK
CENTERED

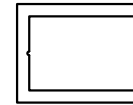
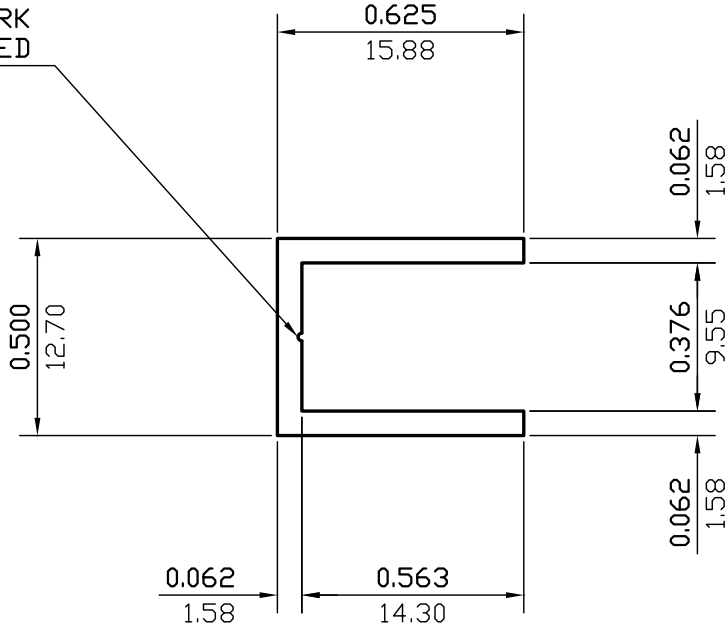

ACTUAL SIZE

NOTE: BREAK ALL CORNERS WITH 0.015" (.38 MM) RADIUS UNLESS OTHERWISE NOTED. STANDARD TOLERANCES TO APPLY UNLESS OTHERWISE SPECIFIED.

WALL THICKNESS 0.062 (1.58) EXCEPT AS SHOWN

DATE	REV	DESCRIPTION	BY
03/20/23	2	REMOVED EXPOSED SURFACES AND ALLOY	JASON
08/23/99	1	REDRAWN	P.M.
EST.AREA	0.101	IN. ²	EST.AREA 65
			MM. ²
EST.WT.	0.119	LBS/FT.	EST.WT. 0.177
			KG/M.
EST.PER.	3.387	IN.	EST.PER. 86.0
			MM.
OUT PER.		IN.	OUT PER.
			MM.
C.C.D.	0.800	IN.	C.C.D. 20
			MM.
FACTOR	29	FINISH PAINT/ANOD.	ALLOY & TEMP.
CKD BY	SCALE 2:1	DWN BY G.M.	DATE 02/07/89

CAN ART

ALUMINUM EXTRUSION INC.

85 PARKSHORE DRIVE
BRAMPTON, ONT L6T 5M1
TEL. NO. (905) 791-1464
FAX NO. (905) 791-9151
E-MAIL: canart@canart.com

THIS DRAWING IS NOT NECESSARILY A COPY OF YOUR ORIGINAL. PLEASE APPROVE DIMENSIONS AND TOLERANCES INDICATED. CAN ART ASSUMES NO RESPONSIBILITY EITHER TECHNICAL OR LEGAL FOR HAVING THIS SHAPE MADE. THE CUSTOMER AGREES TO FULLY PROTECT CAN ART ALUMINUM FROM CLAIMS OF OTHERS RESULTING FROM THIS SHAPE.

SIGNED: _____ DATE: _____