

NOTE: BREAK ALL CORNERS WITH 0.015" (.38 MM) RADIUS UNLESS OTHERWISE NOTED. STANDARD TOLERANCES TO APPLY UNLESS OTHERWISE SPECIFIED.

CUSTOMER PART No.	CUSTOMER <b>CAN ART STD.</b>	DIE No. <b>ES05602</b>
DESCRIPTION	1.000" x .750" x .125" ANGLE	PROPOSAL No. S-7712

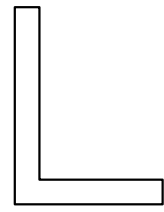
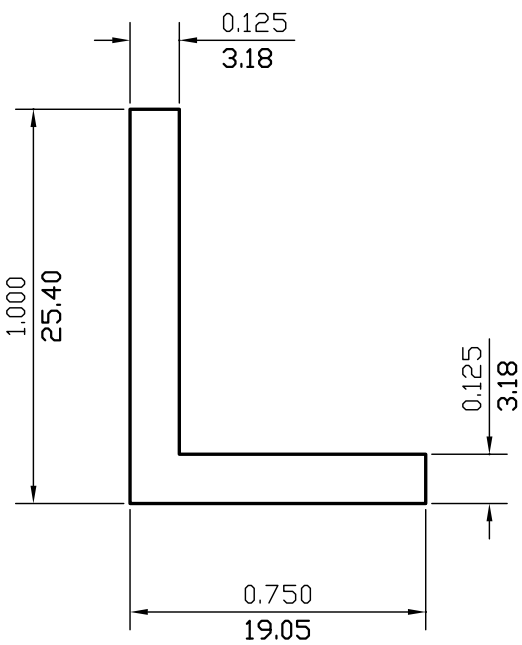

ACTUAL SIZE

WALL THICKNESS 0.125 (3.18) EXCEPT AS SHOWN

DATE	REV	DESCRIPTION	BY
03/20/23	2	REMOVED ALLDLY	JASON
10/05/00	1	UPDATED DRAWING	P.M.
EST.AREA	0.203	IN. <sup>2</sup>	EST.AREA 131.049
			MM. <sup>2</sup>
EST.WT.	0.240	LBS/FT.	EST.WT. 0.357
			KG/M.
EST.PER.	3.500	IN.	EST.PER. 88.900
			MM.
OUT PER.		IN.	OUT PER.
			MM.
C.C.D.	1.250	IN.	C.C.D. 31.750
			MM.
FACTOR	15	FINISH	M/F
		ALLOY & TEMP.	
CKD BY	SCALE 2:1	DWN BY	C.P. DATE 05/19/98

# CAN ART

ALUMINUM EXTRUSION INC.

85 PARKSHORE DRIVE  
BRAMPTON, ONT L6T 5M1  
TEL. NO. (905) 791-1464  
FAX NO. (905) 791-9151  
E-MAIL: canart@canart.com

THIS DRAWING IS NOT NECESSARILY A COPY OF YOUR ORIGINAL. PLEASE APPROVE DIMENSIONS AND TOLERANCES INDICATED. CAN ART ASSUMES NO RESPONSIBILITY EITHER TECHNICAL OR LEGAL FOR HAVING THIS SHAPE MADE. THE CUSTOMER AGREES TO FULLY PROTECT CAN ART ALUMINUM FROM CLAIMS OF OTHERS RESULTING FROM THIS SHAPE.

SIGNED: \_\_\_\_\_ DATE: \_\_\_\_\_