

NOTE: BREAK ALL CORNERS WITH 0.015" (.38 MM) RADIUS UNLESS OTHERWISE NOTED. STANDARD TOLERANCES TO APPLY UNLESS OTHERWISE SPECIFIED.

CUSTOMER PART No.	CUSTOMER <b>CAN ART OPEN</b>	DIE No. <b>ES11899</b>
DESCRIPTION <b>BEVELLED FLAT BAR</b>		PROPOSAL No. <b>S-11314</b>

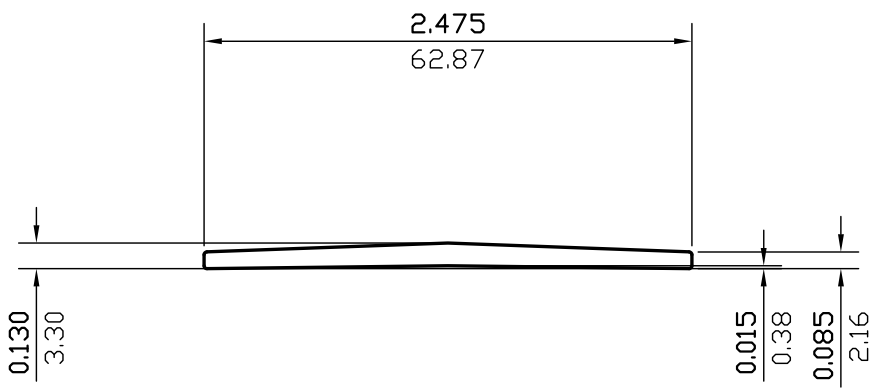

1  
EXPOSED ALL AROUND

WALL THICKNESS **AS SHOWN** EXCEPT AS SHOWN

DATE	REV	DESCRIPTION	BY
09/25/2012	2	MADE CAN ART OPEN	TIND'
02/23/06	1	ADDED EXPOSED SURFACES.	PAUL
EST.AREA	0.247	IN. <sup>2</sup>	EST.AREA 159.557
			MM. <sup>2</sup>
EST.WT.	0.292	LBS/FT.	EST.WT. 0.434
			KG/M.
EST.PER.	5.097	IN.	EST.PER. 129.457
			MM.
OUT PER.		IN.	OUT PER.
			MM.
C.C.D.	2.476	IN.	C.C.D. 62.881
			MM.
FACTOR	17	FINISH	M/F
		ALLOY & TEMP.	6063
CKD BY	SCALE 1:1	DWN BY	C.P. DATE 06/18/2001

# CAN ART

ALUMINUM EXTRUSION INC.

85 PARKSHORE DRIVE  
BRAMPTON, ONT L6T 5M1  
TEL. NO. (905) 791-1464  
FAX NO. (905) 791-9151  
E-MAIL: canart@canart.com

THIS DRAWING IS NOT NECESSARILY A COPY OF YOUR ORIGINAL. PLEASE APPROVE DIMENSIONS AND TOLERANCES INDICATED. CAN ART ASSUMES NO RESPONSIBILITY EITHER TECHNICAL OR LEGAL FOR HAVING THIS SHAPE MADE. THE CUSTOMER AGREES TO FULLY PROTECT CAN ART ALUMINUM FROM CLAIMS OF OTHERS RESULTING FROM THIS SHAPE.

SIGNED: \_\_\_\_\_ DATE: \_\_\_\_\_