

NOTE: BREAK ALL CORNERS WITH 0.015" (.38 MM) RADIUS UNLESS OTHERWISE NOTED. STANDARD TOLERANCES TO APPLY UNLESS OTHERWISE SPECIFIED.

CUSTOMER PART No.	CAN ART STD.	DIE No. EH05658
DESCRIPTION	1.250" O.D. x .095" ROUND TUBE	PROPOSAL No. H-9738

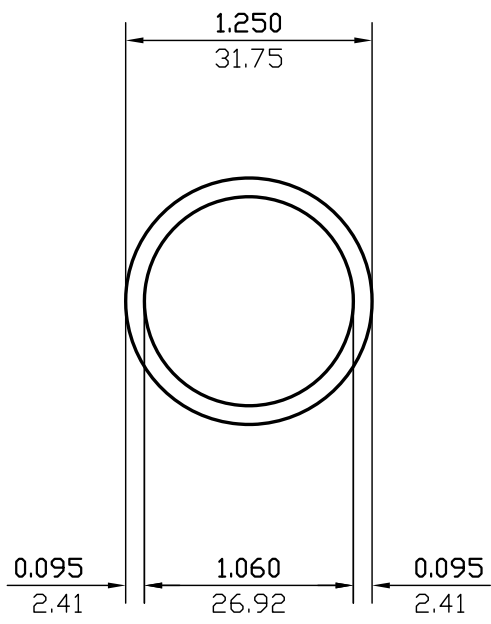

WALL THICKNESS **0.095(2.41)** EXCEPT AS SHOWN

DATE	REV	DESCRIPTION	BY
03/10/23	1	REMOVED ALLOY	JASON
EST.AREA	0.345	IN. ²	EST.AREA
EST.WT.	0.407	LBS/FT.	EST.WT.
EST.PER.	7.257	IN.	EST.PER.
OUT PER.	3.927	IN.	OUT PER.
C.C.D.	1.250	IN.	C.C.D.
FACTOR	18	FINISH	M/F
CKD BY	SCALE	1:1	DWN BY
			C.P.
			DATE
			05/04/00

CAN ART

ALUMINUM EXTRUSION INC.

85 PARKSHORE DRIVE
BRAMPTON, ONT L6T 5M1
TEL. NO. (905) 791-1464
FAX NO. (905) 791-9151
E-MAIL: canart@canart.com

THIS DRAWING IS NOT NECESSARILY A COPY OF YOUR ORIGINAL. PLEASE APPROVE DIMENSIONS AND TOLERANCES INDICATED. CAN ART ASSUMES NO RESPONSIBILITY EITHER TECHNICAL OR LEGAL FOR HAVING THIS SHAPE MADE. THE CUSTOMER AGREES TO FULLY PROTECT CAN ART ALUMINUM FROM CLAIMS OF OTHERS RESULTING FROM THIS SHAPE.

SIGNED: _____ DATE: _____