

NOTE: BREAK ALL CORNERS WITH 0.015" (.38 MM) RADIUS UNLESS OTHERWISE NOTED. STANDARD TOLERANCES TO APPLY UNLESS OTHERWISE SPECIFIED.

CUSTOMER PART No.	<b>CAN ART STD.</b> CUSTOMER	DIE No. <b>ES05662</b>
DESCRIPTION <b>.750" x .750" x .125" ANGLE</b>		PROPOSAL No. <b>S-9876</b>

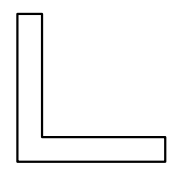
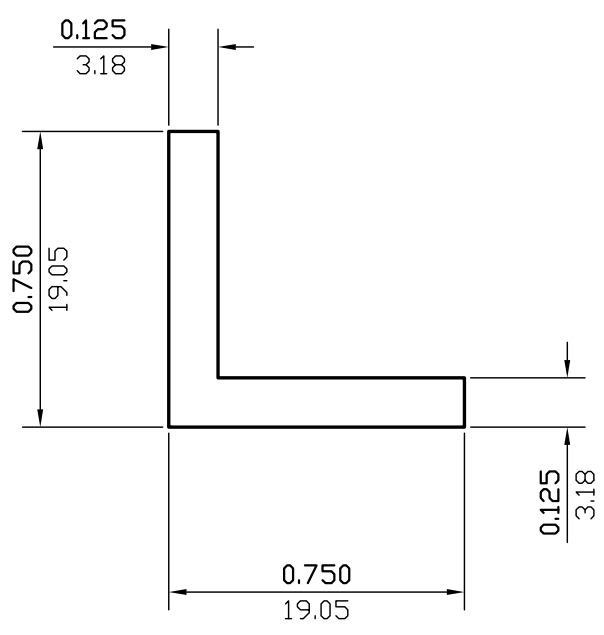

ACTUAL SIZE

WALL THICKNESS **0.125(3.18)** EXCEPT AS SHOWN

DATE	REV	DESCRIPTION	BY
03/20/23	1	REMOVED ALLOY	JASON
EST.AREA	0.172	IN. <sup>2</sup>	EST.AREA 110.888
			MM. <sup>2</sup>
EST.WT.	0.203	LBS/FT.	EST.WT. 0.302
			KG/M.
EST.PER.	3.000	IN.	EST.PER. 76.200
			MM.
OUT PER.		IN.	OUT PER.
			MM.
C.C.D.	1.061	IN.	C.C.D. 26.941
			MM.
FACTOR	15	FINISH	M/F
		ALLOY & TEMP.	
CKD BY	SCALE 2:1	DWN BY	C.P. DATE 06/21/2000

# CAN ART

**ALUMINUM EXTRUSION INC.**

85 PARKSHORE DRIVE  
 BRAMPTON, ONT L6T 5M1  
 TEL. NO. (905) 791-1464  
 FAX NO. (905) 791-9151  
 E-MAIL: canart@canart.com

THIS DRAWING IS NOT NECESSARILY A COPY OF YOUR ORIGINAL. PLEASE APPROVE DIMENSIONS AND TOLERANCES INDICATED. CAN ART ASSUMES NO RESPONSIBILITY EITHER TECHNICAL OR LEGAL FOR HAVING THIS SHAPE MADE. THE CUSTOMER AGREES TO FULLY PROTECT CAN ART ALUMINUM FROM CLAIMS OF OTHERS RESULTING FROM THIS SHAPE.

SIGNED: \_\_\_\_\_ DATE: \_\_\_\_\_