

CUSTOMER

# CAN ART STANDARD

DIE No.

EH61762

REV. No.

1

DESCRIPTION

1.000" x 0.600" x 0.050" THK. REC. TUBE

CUSTOMER PART No.

QUOTE No.

L07-0196-6

PROPOSAL No.

H-55147

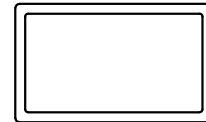
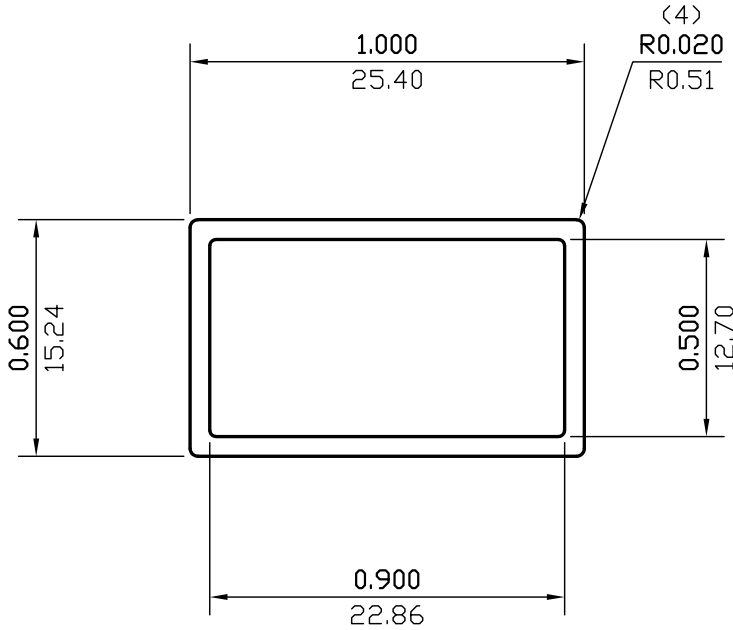

ACTUAL SIZE

NOTE: BREAK ALL CORNERS WITH 0.015" (.38 MM) RADIUS UNLESS OTHERWISE NOTED. STANDARD TOLERANCES TO APPLY UNLESS OTHERWISE SPECIFIED.

WALL THICKNESS 0.050 (1.27) EXCEPT AS SHOWN

DATE	REV	DESCRIPTION	BY
03/15/23	1	REMOVED EXPOSED SURFACES AND ALLOY	JASON
EST.AREA	0.150	IN. <sup>2</sup>	EST.AREA 96.678
			MM. <sup>2</sup>
EST.WT.	0.180	LBS/FT.	EST.WT. 0.268
			KG/M.
EST.PER.	5.940	IN.	EST.PER. 150.874
			MM.
OUT PER.	3.166	IN.	OUT PER. 80.4
			MM.
C.C.D.	1.151	IN.	C.C.D. 29.245
			MM.
FINISH	PAINT		ALLOY
CKD BY	FACTOR 33	SCALE 2:1	DWN BY J.T. DATE 11/28/2007

## CAN ART

ALUMINUM EXTRUSION INC.

428 JUTRAS DRIVE S.  
WINDSOR, ON N8N 5C5  
TEL. NO. (519) 727-4399  
FAX NO. (519) 727-6434  
WEB: www.canart.com

THIS DRAWING IS NOT NECESSARILY A COPY OF YOUR ORIGINAL. PLEASE APPROVE DIMENSIONS AND TOLERANCES INDICATED. CAN ART ASSUMES NO RESPONSIBILITY EITHER TECHNICAL OR LEGAL FOR HAVING THIS SHAPE MADE. THE CUSTOMER AGREES TO FULLY PROTECT CAN ART ALUMINUM FROM CLAIMS OF OTHERS RESULTING FROM THIS SHAPE.

SIGNED: \_\_\_\_\_ DATE: \_\_\_\_\_