

CUSTOMER PART No.

CUSTOMER

CAN ART STANDARD

DIE No.

EH60494

DESCRIPTION

3/4" TUBE x .083

PROPOSAL No.

H-51109

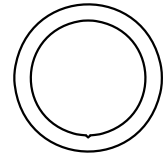
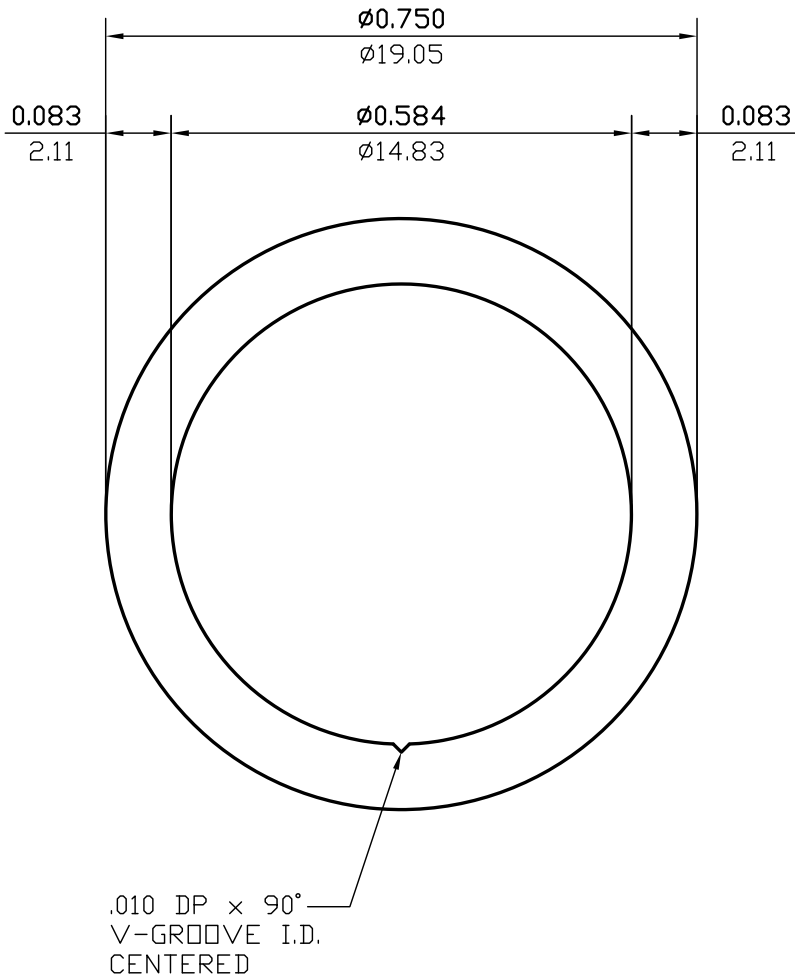

ACTUAL SIZE

NOTE: BREAK ALL CORNERS WITH 0.015" (.38 MM) RADIUS UNLESS OTHERWISE NOTED. STANDARD TOLERANCES TO APPLY UNLESS OTHERWISE SPECIFIED.

WALL THICKNESS 0.083(2.11) EXCEPT AS SHOWN

DATE	REV	DESCRIPTION	BY	
03/10/23	2	REMOVED ALLDYO	JASON	
02/24/11	1	CHANGED CUSTOMER NAME	J.T.	
EST.AREA	0.174	IN. ²	EST.AREA 112.143	MM. ²
EST.WT.	0.209	LBS/FT.	EST.WT. 0.310	KG/M.
EST.PER.	4.199	IN.	EST.PER. 106.663	MM.
OUT PER.	2.356	IN.	OUT PER. 59.8	MM.
C.C.D.	0.750	IN.	C.C.D. 19.050	MM.
FACTOR	20	FINISH	M/F	ALLOY & TEMP.
QKD BY	SCALE	4:1	DWN BY	L.G. DATE 12/23/2002

CAN ART

ALUMINUM EXTRUSION INC.

428 JUTRAS DRIVE S.
WINDSOR, ONT. N8N 5C5
TEL. NO. (519) 727-4399
FAX NO. (519) 727-6434
E-MAIL: canart@canart.com

THIS DRAWING IS NOT NECESSARILY A COPY OF YOUR ORIGINAL. PLEASE APPROVE DIMENSIONS AND TOLERANCES INDICATED. CAN ART ASSUMES NO RESPONSIBILITY EITHER TECHNICAL OR LEGAL FOR HAVING THIS SHAPE MADE. THE CUSTOMER AGREES TO FULLY PROTECT CAN ART ALUMINUM FROM CLAIMS OF OTHERS RESULTING FROM THIS SHAPE.

SIGNED: _____ DATE: _____