

CUSTOMER

# CAN ART STD.

DIE No.

EH05898

REV. No.

2

DESCRIPTION

4" SCHED. 10 PIPE

CUSTOMER PART No.

QUOTE No.

08-0226-2

PROPOSAL No.

H-18961

NOTE: BREAK ALL CORNERS WITH 0.015" (.38 MM) RADIUS UNLESS OTHERWISE NOTED. STANDARD TOLERANCES TO APPLY UNLESS OTHERWISE SPECIFIED.

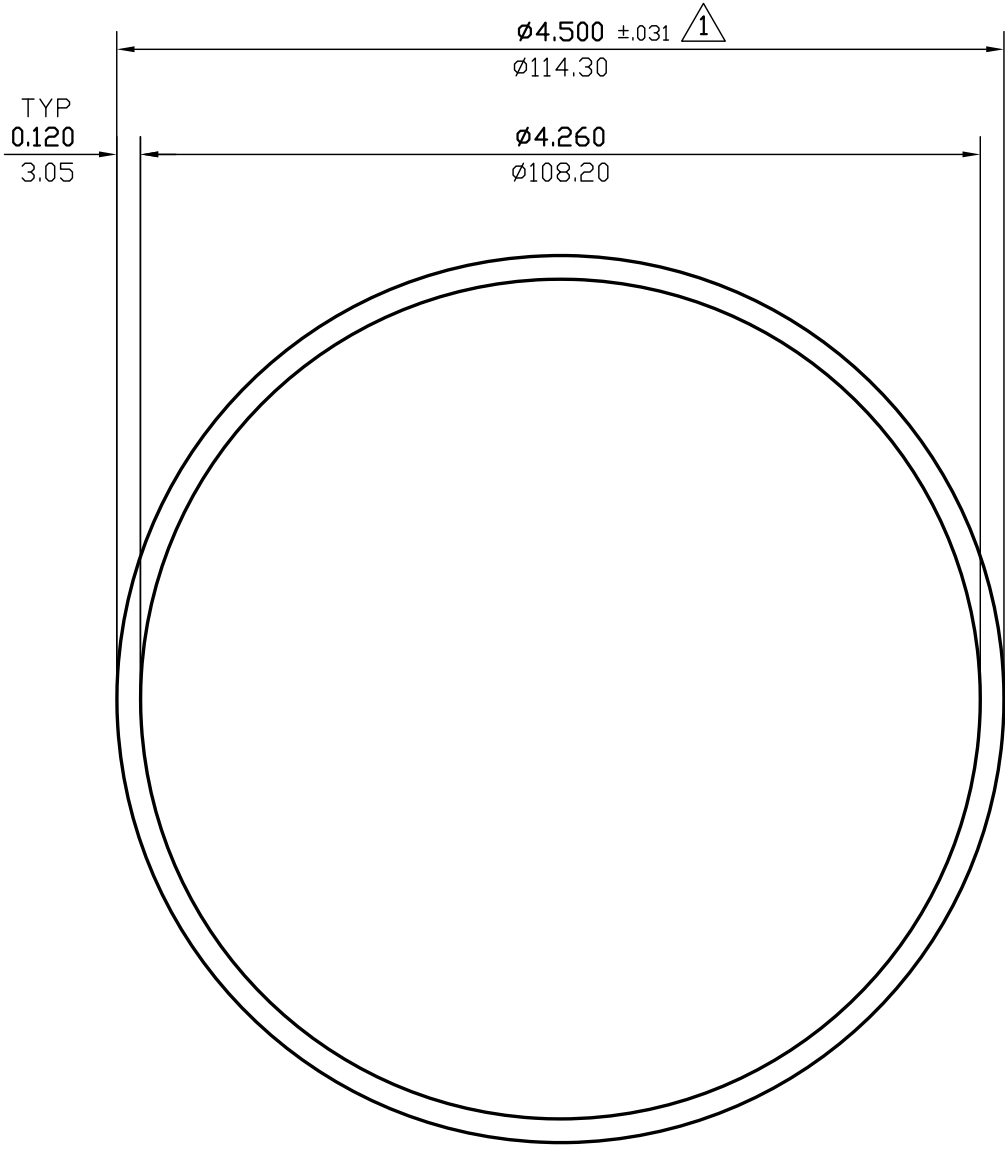

WALL THICKNESS 0.120 (3.05) EXCEPT AS SHOWN

DATE	REV	DESCRIPTION	BY
03/10/23	2	REMOVED ALLOY	JASON
07/16/15	1	ADDED ±0.031 TOLERANCE.	PAUL
EST.AREA	1.651	IN. <sup>2</sup>	EST.AREA 1065.310
			MM. <sup>2</sup>
EST.WT.	1.948	LBS/FT.	EST.WT. 2.900
			KG/M.
EST.PER.	27.520	IN.	EST.PER. 699.017
			MM.
OUT PER.	14.137	IN.	OUT PER. 359.1
			MM.
C.C.D.	4.500	IN.	C.C.D. 114.300
			MM.
FINISH	M/F		ALLOY
CKD BY	FACTOR 14	SCALE 1:1	DWN BY P.M. DATE 06/23/2008

## CAN ART

85 PARKSHORE DRIVE  
BRAMPTON, ONT L6T 5M1  
TEL. NO. (905) 791-1464  
FAX NO. (905) 791-9151  
WEB: www.canart.com

ALUMINUM EXTRUSION INC.

THIS DRAWING IS NOT NECESSARILY A COPY OF YOUR ORIGINAL. PLEASE APPROVE DIMENSIONS AND TOLERANCES INDICATED. CAN ART ASSUMES NO RESPONSIBILITY EITHER TECHNICAL OR LEGAL FOR HAVING THIS SHAPE MADE. THE CUSTOMER AGREES TO FULLY PROTECT CAN ART ALUMINUM FROM CLAIMS OF OTHERS RESULTING FROM THIS SHAPE.

SIGNED: \_\_\_\_\_ DATE: \_\_\_\_\_