

CUSTOMER PART No.

CUSTOMER

# CAN ART STD.

DIE No.

ES05653

DESCRIPTION

1 x 1 x .250 ANGLE

PROPOSAL No.

S-9519

NOTE: BREAK ALL CORNERS WITH 0.015" (.38 MM) RADIUS UNLESS OTHERWISE NOTED. STANDARD TOLERANCES TO APPLY UNLESS OTHERWISE SPECIFIED.

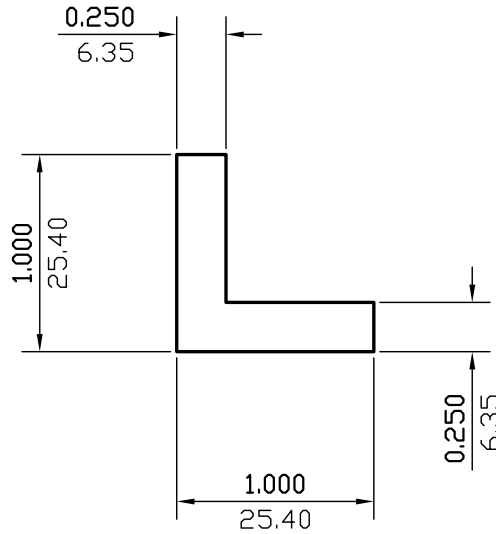

WALL THICKNESS 0.250(6.35) EXCEPT AS SHOWN

DATE	REV	DESCRIPTION	BY
03/20/23	1	REMOVED ALLOY	JASON
EST.AREA	0.437	IN. <sup>2</sup>	EST.AREA 282
			MM. <sup>2</sup>
EST.WT.	0.516	LBS/FT.	EST.WT. 0.768
			KG/M.
EST.PER.	4.000	IN.	EST.PER. 101.6
			MM.
OUT PER.		IN.	OUT PER.
			MM.
C.C.D.	1.414	IN.	C.C.D. 36
			MM.
FACTOR	8	FINISH	M/F
		ALLOY & TEMP.	
CKD BY	SCALE	1:1	DWN BY C.P. DATE 02/16/00

# CAN ART

ALUMINUM EXTRUSION INC.

85 PARKSHORE DRIVE  
BRAMPTON, ONT L6T 5M1  
TEL. NO. (905) 791-1464  
FAX NO. (905) 791-9151  
E-MAIL: canart@canart.com

THIS DRAWING IS NOT NECESSARILY A COPY OF YOUR ORIGINAL. PLEASE APPROVE DIMENSIONS AND TOLERANCES INDICATED. CAN ART ASSUMES NO RESPONSIBILITY EITHER TECHNICAL OR LEGAL FOR HAVING THIS SHAPE MADE. THE CUSTOMER AGREES TO FULLY PROTECT CAN ART ALUMINUM FROM CLAIMS OF OTHERS RESULTING FROM THIS SHAPE.

SIGNED: \_\_\_\_\_ DATE: \_\_\_\_\_