

CUSTOMER PART No.

CUSTOMER

CAN ART STANDARD

DIE No.

EH11598

DESCRIPTION

.750" x 2.000" x .105" RECT. TUBE

PROPOSAL No.

H-10769

NOTE: BREAK ALL CORNERS WITH 0.015" (.38 MM) RADIUS UNLESS OTHERWISE NOTED. STANDARD TOLERANCES TO APPLY UNLESS OTHERWISE SPECIFIED.

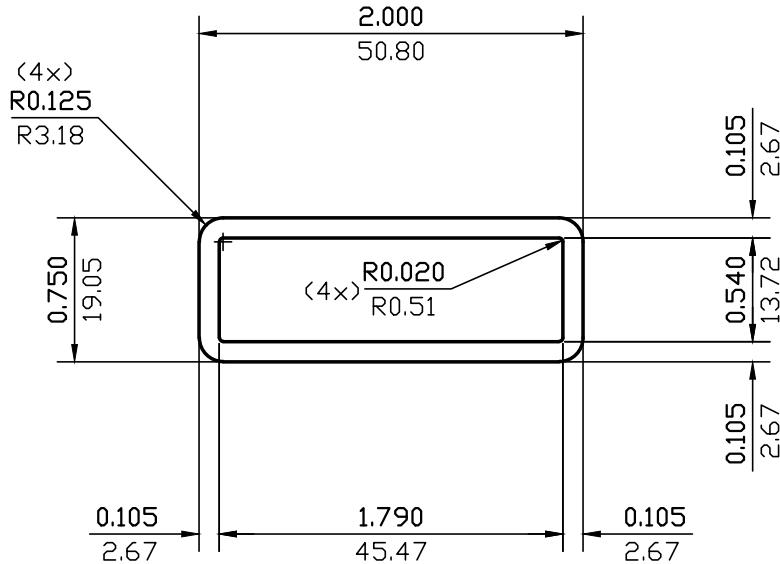

WALL THICKNESS (AS SHOWN) EXCEPT AS SHOWN

| DATE | REV | DESCRIPTION | | BY |
|----------|-------|------------------|----------|---------------|
| | | | | |
| EST.AREA | 0.520 | IN. ² | EST.AREA | 335.699 |
| EST.WT. | 0.624 | LBS./FT. | EST.WT. | 0.929 |
| EST.PER. | 9.911 | IN. | EST.PER. | 251.741 |
| OUT PER. | 5.285 | IN. | OUT PER. | 134.2 |
| C.C.D. | 2.062 | IN. | C.C.D. | 52.363 |
| FACTOR | 16 | FINISH | M/F | ALLOY & TEMP. |
| CKD BY | SCALE | 1:1 | DWN BY | C.P. DATE |
| | | | | 01/30/2001 |

CAN ART

ALUMINUM EXTRUSION INC.

85 PARKSHORE DRIVE
BRAMPTON, ONT L6T 5M1
TEL. NO. (905) 791-1464
FAX NO. (905) 791-9151
E-MAIL: canart@canart.com

THIS DRAWING IS NOT NECESSARILY A COPY OF YOUR ORIGINAL. PLEASE APPROVE DIMENSIONS AND TOLERANCES INDICATED. CAN ART ASSUMES NO RESPONSIBILITY EITHER TECHNICAL OR LEGAL FOR HAVING THIS SHAPE MADE. THE CUSTOMER AGREES TO FULLY PROTECT CAN ART ALUMINUM FROM CLAIMS OF OTHERS RESULTING FROM THIS SHAPE.

SIGNED: _____ DATE: _____