

NOTE: BREAK ALL CORNERS WITH 0.015" (.38 MM) RADIUS UNLESS OTHERWISE NOTED. STANDARD TOLERANCES TO APPLY UNLESS OTHERWISE SPECIFIED.

CUSTOMER	<b>CAN ART STD.</b>	DIE No. <b>EH05992</b>	REV. No. <b>1</b>
DESCRIPTION <b>2.500 x 0.250 SQ. TUBE</b>	CUSTOMER PART No.	QUOTE No. <b>11-1030-1</b>	PROPOSAL No. <b>H-25171</b>

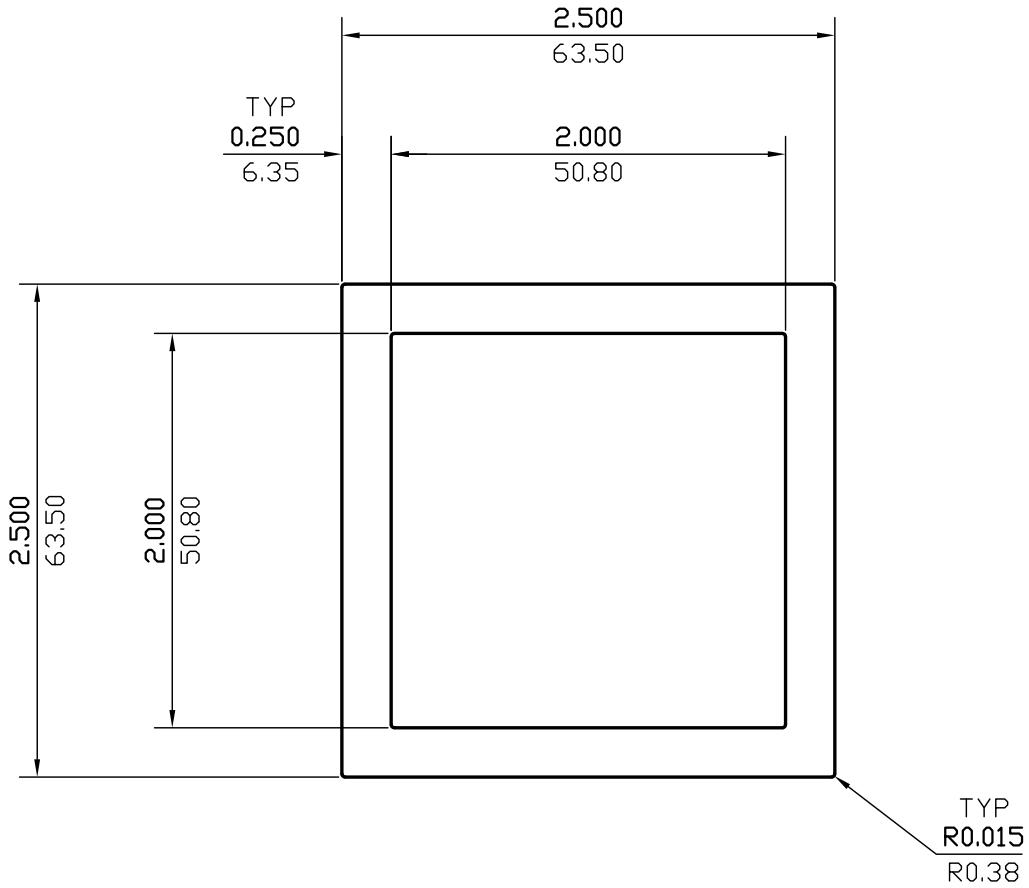

WALL THICKNESS **0.250 (6.35)** EXCEPT AS SHOWN

DATE	REV	DESCRIPTION	BY
03/13/23	1	REMOVED ALLOY	JASON
EST. AREA		2.250 IN. <sup>2</sup>	EST. AREA 1451.621 MM. <sup>2</sup>
EST. WT.		2.655 LBS/FT.	EST. WT. 3.951 KG/M.
EST. PER.		17.948 IN.	EST. PER. 455.892 MM.
OUT PER.		9.974 IN.	OUT PER. 253.3 MM.
C.C.D.		3.523 IN.	C.C.D. 89.487 MM.
FINISH		M/F	ALLOY
CKD BY	FACTOR	SCALE	DWN BY DATE
	7	1:1	P.M. 11/02/2011

# CAN ART

ALUMINUM EXTRUSION INC.

85 PARKSHORE DRIVE  
BRAMPTON, ONT L6T 5M1  
TEL. NO. (905) 791-1464  
FAX NO. (905) 791-9151  
WEB: www.canart.com

THIS DRAWING IS NOT NECESSARILY A COPY OF YOUR ORIGINAL. PLEASE APPROVE DIMENSIONS AND TOLERANCES INDICATED. CAN ART ASSUMES NO RESPONSIBILITY EITHER TECHNICAL OR LEGAL FOR HAVING THIS SHAPE MADE. THE CUSTOMER AGREES TO FULLY PROTECT CAN ART ALUMINUM FROM CLAIMS OF OTHERS RESULTING FROM THIS SHAPE.

SIGNED: \_\_\_\_\_ DATE: \_\_\_\_\_