

CUSTOMER PART No.	CUSTOMER	DIE No.
	CAN ART STD.	EH05707
DESCRIPTION	3" x 3" x 0.085" THICK SQ. TUBE	PROPOSAL No. H-50042

NOTE: BREAK ALL CORNERS WITH 0.015" (.38 MM) RADIUS UNLESS OTHERWISE NOTED. STANDARD TOLERANCES TO APPLY UNLESS OTHERWISE SPECIFIED.

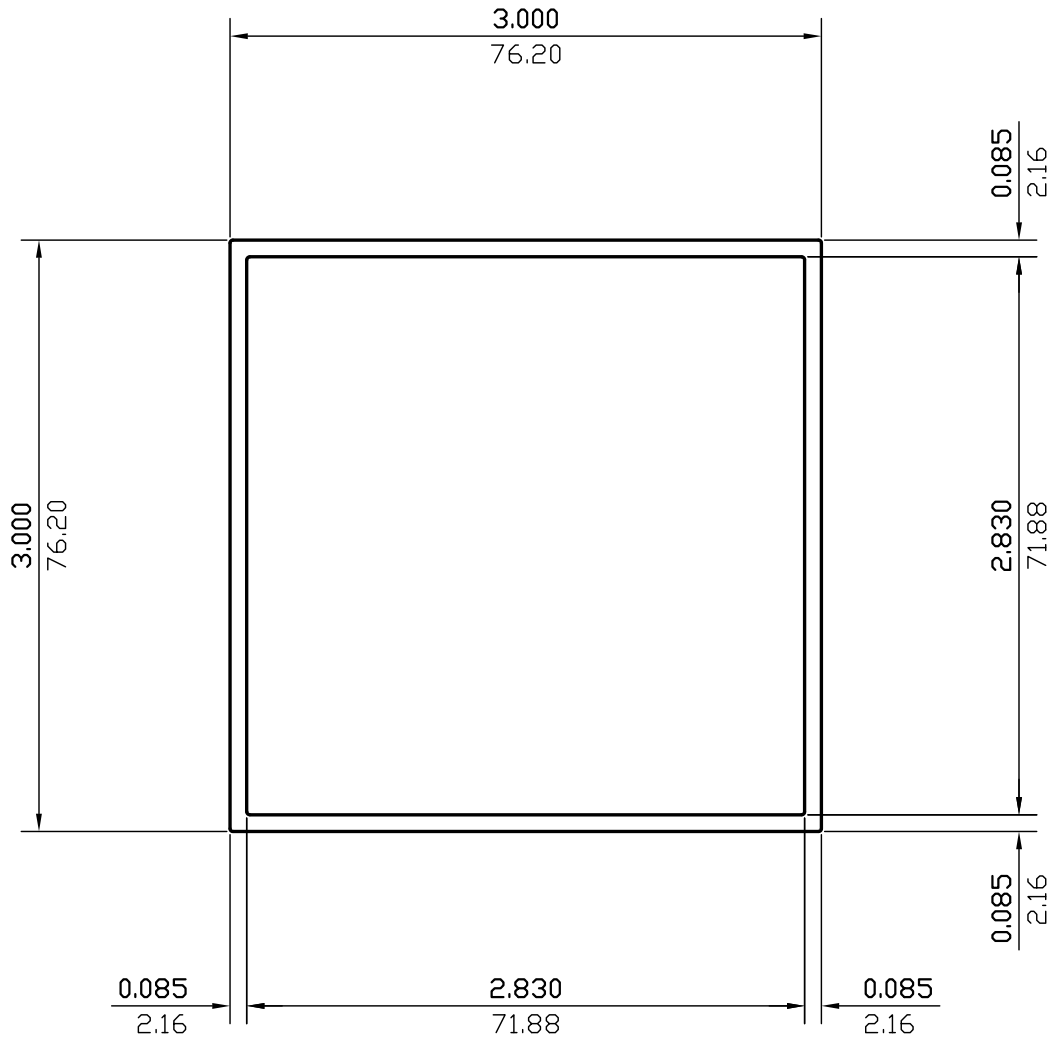

WALL THICKNESS **0.085 (2.16)** EXCEPT AS SHOWN

DATE	REV	DESCRIPTION	BY
03/13/23	1	REMOVED ALLOY	JASON
EST.AREA	0.991	IN. ²	EST.AREA 639.423 MM. ²
EST.WT.	1.169	LBS./FT.	EST.WT. 1.740 KG/M.
EST.PER.	23.268	IN.	EST.PER. 591.020 MM.
OUT PER.	11.974	IN.	OUT PER. 304.1 MM.
C.C.D.	4.230	IN.	C.C.D. 107.447 MM.
FACTOR	20	FINISH M/F	ALLOY & TEMP.
CKD BY	SCALE 1:1	DWN BY P.M.	DATE 05/19/2001

CAN ART

85 PARKSHORE DRIVE
BRAMPTON, ONT L6T 5M1
TEL. NO. (905) 791-1464
FAX NO. (905) 791-9151
E-MAIL: canart@canart.com

ALUMINUM EXTRUSION INC.

THIS DRAWING IS NOT NECESSARILY A COPY OF YOUR ORIGINAL. PLEASE APPROVE DIMENSIONS AND TOLERANCES INDICATED. CAN ART ASSUMES NO RESPONSIBILITY EITHER TECHNICAL OR LEGAL FOR HAVING THIS SHAPE MADE. THE CUSTOMER AGREES TO FULLY PROTECT CAN ART ALUMINUM FROM CLAIMS OF OTHERS RESULTING FROM THIS SHAPE.

SIGNED: _____ DATE: _____