

NOTE: BREAK ALL CORNERS WITH 0.015" (.38 MM) RADIUS UNLESS OTHERWISE NOTED. STANDARD TOLERANCES TO APPLY UNLESS OTHERWISE SPECIFIED.

CUSTOMER PART No.	CAN ART STD.	DIE No. EH05654
DESCRIPTION	2" x 2" x .100" SQ. TUBE	PROPOSAL No. H-9556

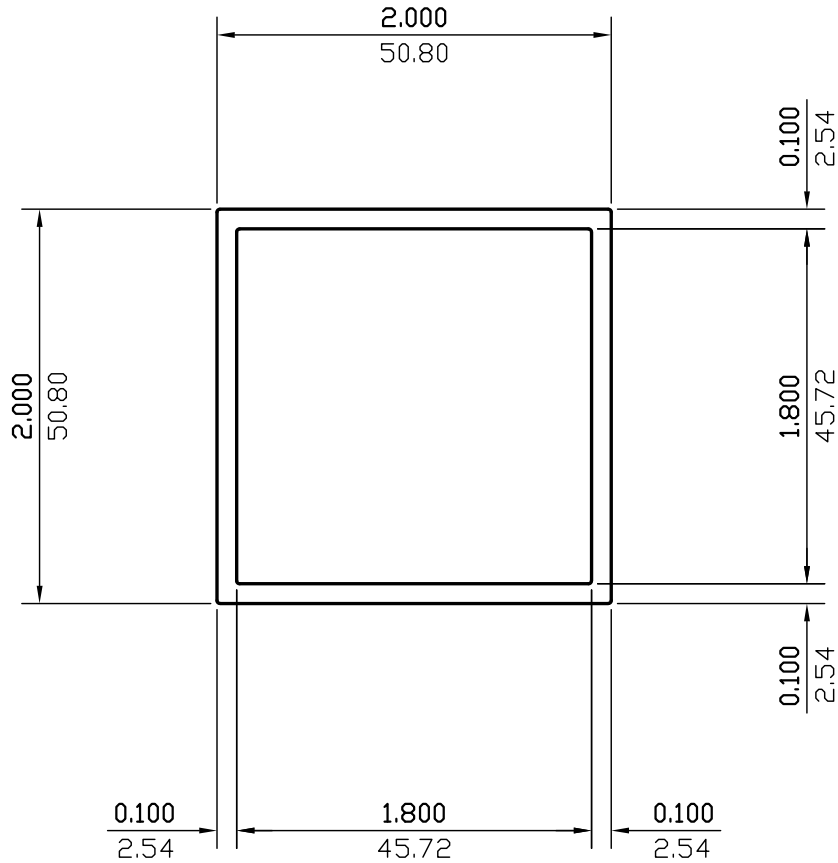

WALL THICKNESS 0.100(2.54) EXCEPT AS SHOWN

DATE	REV	DESCRIPTION	BY		
03/13/23	1	REMOVED ALLOY	JASON		
EST.AREA	0.760	IN. ²	EST.AREA	490	MM. ²
EST.WT.	0.897	LBS/FT.	EST.WT.	1.335	KG/M.
EST.PER.	15.200	IN.	EST.PER.	386.1	MM.
OUT PER.	8.000	IN.	OUT PER.	203.2	MM.
C.C.D.	2.828	IN.	C.C.D.	72	MM.
FACTOR	17	FINISH	M/F	ALLOY & TEMP.	
CKD BY		SCALE	1:1	DWN BY	C.P. DATE 02/24/00

CAN ART

ALUMINUM EXTRUSION INC.

85 PARKSHORE DRIVE
BRAMPTON, ONT L6T 5M1
TEL. NO. (905) 791-1464
FAX NO. (905) 791-9151
E-MAIL: canart@canart.com

THIS DRAWING IS NOT NECESSARILY A COPY OF YOUR ORIGINAL. PLEASE APPROVE DIMENSIONS AND TOLERANCES INDICATED. CAN ART ASSUMES NO RESPONSIBILITY EITHER TECHNICAL OR LEGAL FOR HAVING THIS SHAPE MADE. THE CUSTOMER AGREES TO FULLY PROTECT CAN ART ALUMINUM FROM CLAIMS OF OTHERS RESULTING FROM THIS SHAPE.

SIGNED: _____ DATE: _____