

CUSTOMER PART No.	CUSTOMER CAN ART STD.	DIE No. EH05636
DESCRIPTION 2" x 1-1/2" x .125" R.C. RECT. TUBE	PROPOSAL No. H-8751	

NOTE: BREAK ALL CORNERS WITH 0.015" (.38 MM) RADIUS UNLESS OTHERWISE NOTED. STANDARD TOLERANCES TO APPLY UNLESS OTHERWISE SPECIFIED.

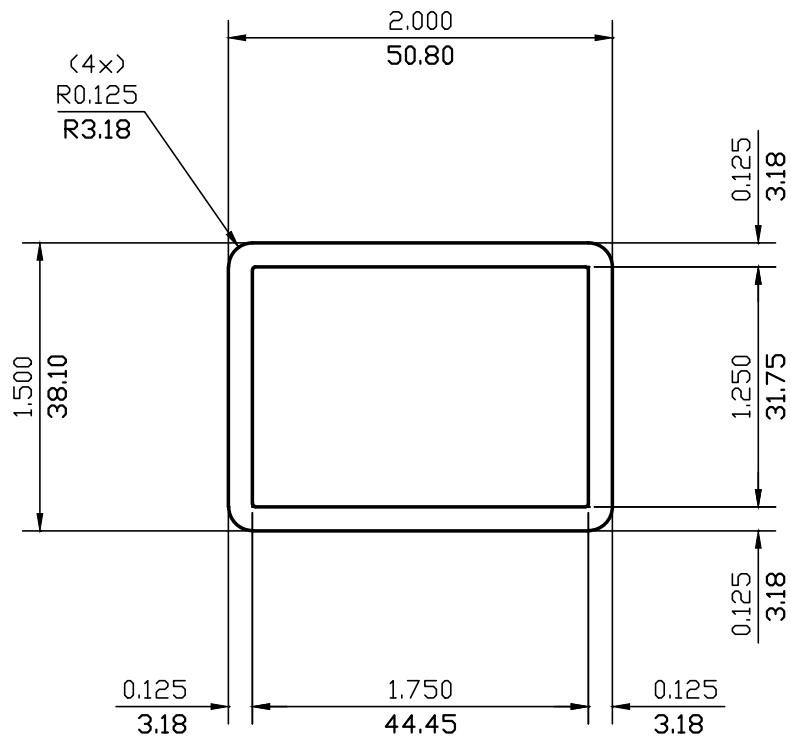

WALL THICKNESS **0.125 (3.18)** EXCEPT AS SHOWN

DATE	REV	DESCRIPTION	BY
EST.AREA	0.799	IN. ²	EST.AREA 515.668 MM. ²
EST.WT.	0.943	LBS./FT.	EST.WT. 1.404 KG/M.
EST.PER.	12.760	IN.	EST.PER. 324.095 MM.
OUT PER.	6.785	IN.	OUT PER. 172.3 MM.
C.C.D.	2.398	IN.	C.C.D. 60.897 MM.
FACTOR 14	FINISH M/F	ALLOY & TEMP. 6061	
CKD BY	SCALE 1:1	DWN BY C.P.	DATE 06/18/99

CAN ART

85 PARKSHORE DRIVE
BRAMPTON, ONT L6T 5M1
TEL. NO. (905) 791-1464
FAX NO. (905) 791-9151
E-MAIL: canart@canart.com

ALUMINUM EXTRUSION INC.

THIS DRAWING IS NOT NECESSARILY A COPY OF YOUR ORIGINAL. PLEASE APPROVE DIMENSIONS AND TOLERANCES INDICATED. CAN ART ASSUMES NO RESPONSIBILITY EITHER TECHNICAL OR LEGAL FOR HAVING THIS SHAPE MADE. THE CUSTOMER AGREES TO FULLY PROTECT CAN ART ALUMINUM FROM CLAIMS OF OTHERS RESULTING FROM THIS SHAPE.

SIGNED: _____ DATE: _____