

CUSTOMER PART No.

CUSTOMER

CAN ART STD.

DIE No.

EH05582

DESCRIPTION

5/8" x 5/8" x 0.065" THK. SQ. TUBE

PROPOSAL No.

H-6946

NOTE: BREAK ALL CORNERS WITH 0.015" (.38 MM) RADIUS UNLESS OTHERWISE NOTED. STANDARD TOLERANCES TO APPLY UNLESS OTHERWISE SPECIFIED.

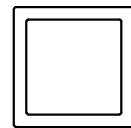
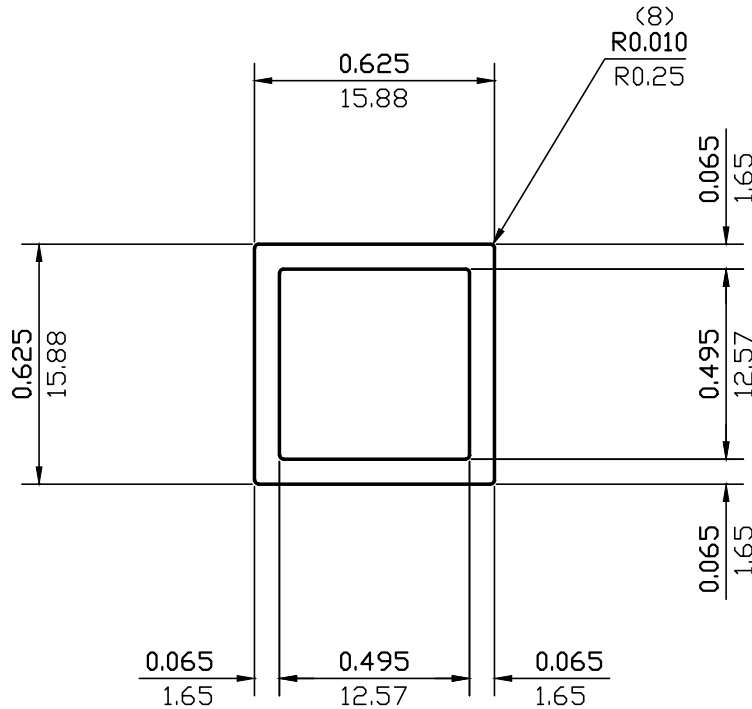

ACTUAL SIZE

WALL THICKNESS 0.065 (1.65) EXCEPT AS SHOWN

DATE	REV	DESCRIPTION	BY
EST.AREA	0.146	IN. ²	EST.AREA 94
EST.WT.	0.172	LBS/FT.	EST.WT. 0.256
EST.PER.	4.446	IN.	EST.PER. 112.9
OUT PER.	2.483	IN.	OUT PER. 63.1
C.C.D.	0.876	IN.	C.C.D. 22
FACTOR	26	FINISH M/F	ALLOY & TEMP. 6063
CKD BY	SCALE 2:1	DWN BY C.P.	DATE 10/07/97

CAN ART

ALUMINUM EXTRUSION INC.

85 PARKSHORE DRIVE
BRAMPTON, ONT L6T 5M1
TEL. NO. (905) 791-1464
FAX NO. (905) 791-9151
E-MAIL: canart@canart.com

THIS DRAWING IS NOT NECESSARILY A COPY OF YOUR ORIGINAL. PLEASE APPROVE DIMENSIONS AND TOLERANCES INDICATED. CAN ART ASSUMES NO RESPONSIBILITY EITHER TECHNICAL OR LEGAL FOR HAVING THIS SHAPE MADE. THE CUSTOMER AGREES TO FULLY PROTECT CAN ART ALUMINUM FROM CLAIMS OF OTHERS RESULTING FROM THIS SHAPE.

SIGNED: _____ DATE: _____