

NOTE: BREAK ALL CORNERS WITH 0.015" (.38 MM) RADIUS UNLESS OTHERWISE NOTED. STANDARD TOLERANCES TO APPLY UNLESS OTHERWISE SPECIFIED.

CUSTOMER PART No.	CAN ART STD.	DIE No. EH05413
DESCRIPTION	3/4" x 3/4" x 0.055" THK. SQ. TUBE	PROPOSAL No. H-2929

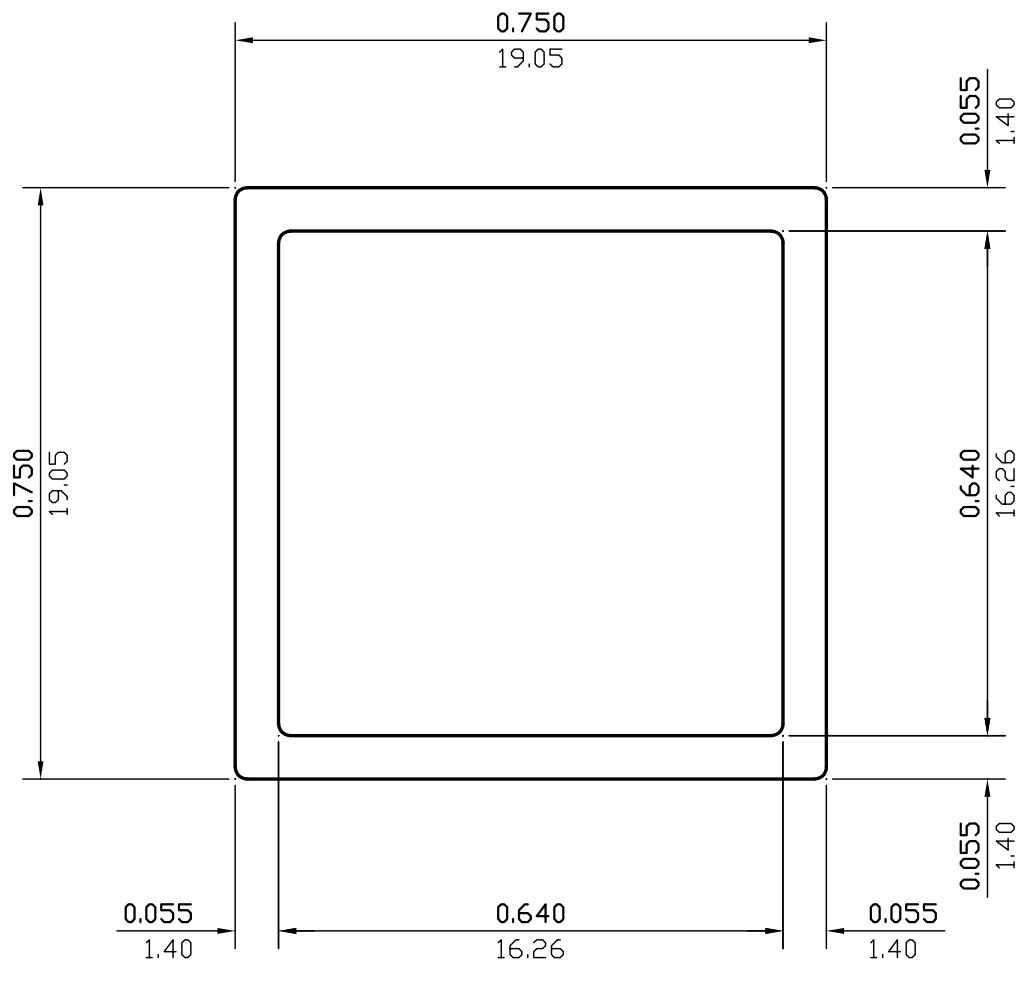

ACTUAL SIZE

WALL THICKNESS **0.055 (1.40)** EXCEPT AS SHOWN

DATE	REV	DESCRIPTION	BY
03/13/23	2	REMOVED ALLOY	JASON
08/05/99	1	REDRAWN	P.M.
EST.AREA	0.153	IN. ²	EST.AREA 99 MM. ²
EST.WT.	0.180	LBS/FT.	EST.WT. 0.269 KG/M.
EST.PER.	5.560	IN.	EST.PER. 141.2 MM.
OUT PER.	3.000	IN.	OUT PER. 76.2 MM.
C.C.D.	1.061	IN.	C.C.D. 27 MM.
FACTOR 31	FINISH M/F	ALLOY & TEMP.	
CKD BY	SCALE 4:1	DWN BY C.P.	DATE 04/05/93

CAN ART

ALUMINUM EXTRUSION INC.

85 PARKSHORE DRIVE
BRAMPTON, ONT L6T 5M1
TEL. NO. (905) 791-1464
FAX NO. (905) 791-9151
E-MAIL: canart@canart.com

THIS DRAWING IS NOT NECESSARILY A COPY OF YOUR ORIGINAL. PLEASE APPROVE DIMENSIONS AND TOLERANCES INDICATED. CAN ART ASSUMES NO RESPONSIBILITY EITHER TECHNICAL OR LEGAL FOR HAVING THIS SHAPE MADE. THE CUSTOMER AGREES TO FULLY PROTECT CAN ART ALUMINUM FROM CLAIMS OF OTHERS RESULTING FROM THIS SHAPE.

SIGNED: _____ DATE: _____