

NOTE: BREAK ALL CORNERS WITH 0.015" (.38 MM) RADIUS UNLESS OTHERWISE SPECIFIED. STANDARD TOLERANCES TO APPLY UNLESS OTHERWISE SPECIFIED.

CUSTOMER PART No.	CAN ART STD.	DIE No. EH05394
DESCRIPTION	1" x 1" x 0.120" THK. SQ. TUBE	PROPOSAL No. H-2027

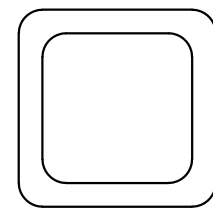
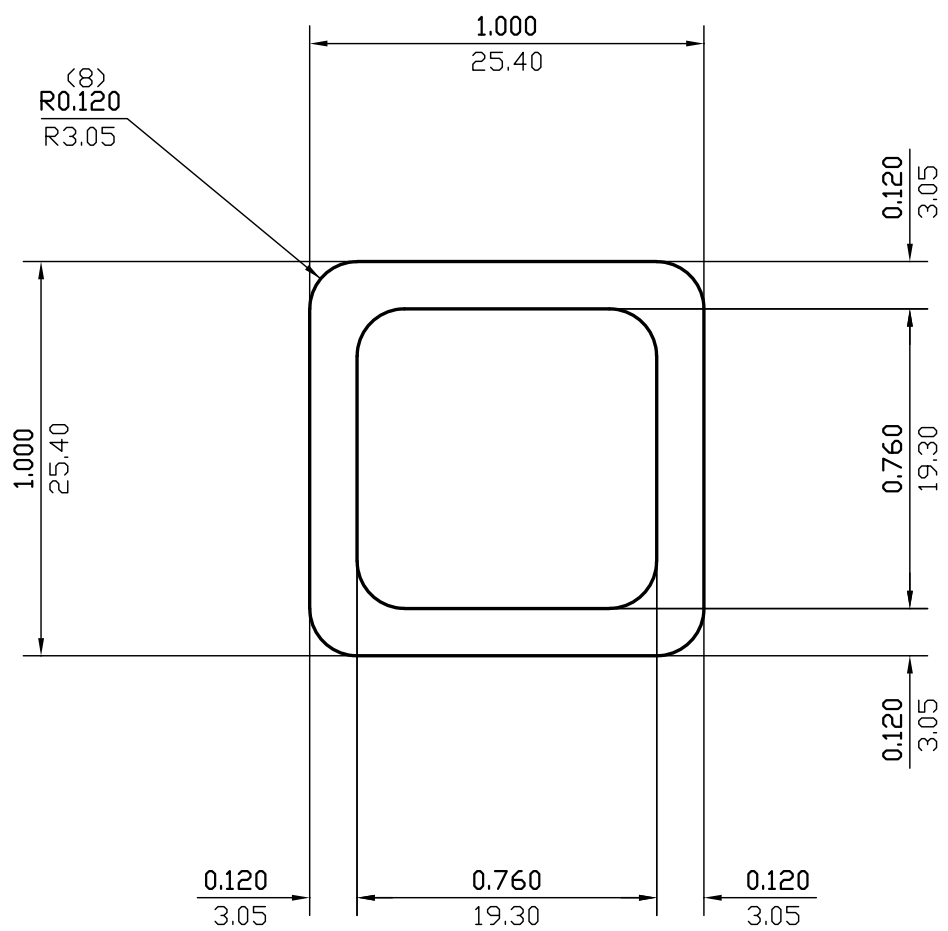

ACTUAL SIZE

WALL THICKNESS 0.120 (3.05) EXCEPT AS SHOWN

DATE	REV	DESCRIPTION	BY
03/13/23	2	REMOVED ALLOY	JASON
08/06/99	1	REDRAWN	P.M.
EST. AREA	0.422	IN. ²	EST. AREA 273
			MM. ²
EST. WT.	0.498	LBS/FT.	EST. WT. 0.742
			KG/M.
EST. PER.	6.628	IN.	EST. PER. 168.4
			MM.
OUT PER.	3.794	IN.	OUT PER. 96.4
			MM.
C.C.D.	1.315	IN.	C.C.D. 33
			MM.
FACTOR 13	FINISH M/F	ALLOY & TEMP.	
CKD BY	SCALE 2:1	DWN BY J.D.	DATE 05/13/91

CAN ART

ALUMINUM EXTRUSION INC.

85 PARKSHORE DRIVE
BRAMPTON, ONT L6T 5M1
TEL. NO. (905) 791-1464
FAX NO. (905) 791-9151
E-MAIL: canart@canart.com

THIS DRAWING IS NOT NECESSARILY A COPY OF YOUR ORIGINAL. PLEASE APPROVE DIMENSIONS AND TOLERANCES INDICATED. CAN ART ASSUMES NO RESPONSIBILITY EITHER TECHNICAL OR LEGAL FOR HAVING THIS SHAPE MADE. THE CUSTOMER AGREES TO FULLY PROTECT CAN ART ALUMINUM FROM CLAIMS OF OTHERS RESULTING FROM THIS SHAPE.

SIGNED: _____ DATE: _____