

CUSTOMER PART No.	CUSTOMER	<b>CAN ART OPEN</b>	DIE No.	ES07627
DESCRIPTION		GLASS MEETING RAIL (TOP)	PROPOSAL No.	S-3109

NOTE: BREAK ALL CORNERS WITH 0.015" (.38 MM) RADIUS UNLESS OTHERWISE NOTED. STANDARD TOLERANCES TO APPLY UNLESS OTHERWISE SPECIFIED.

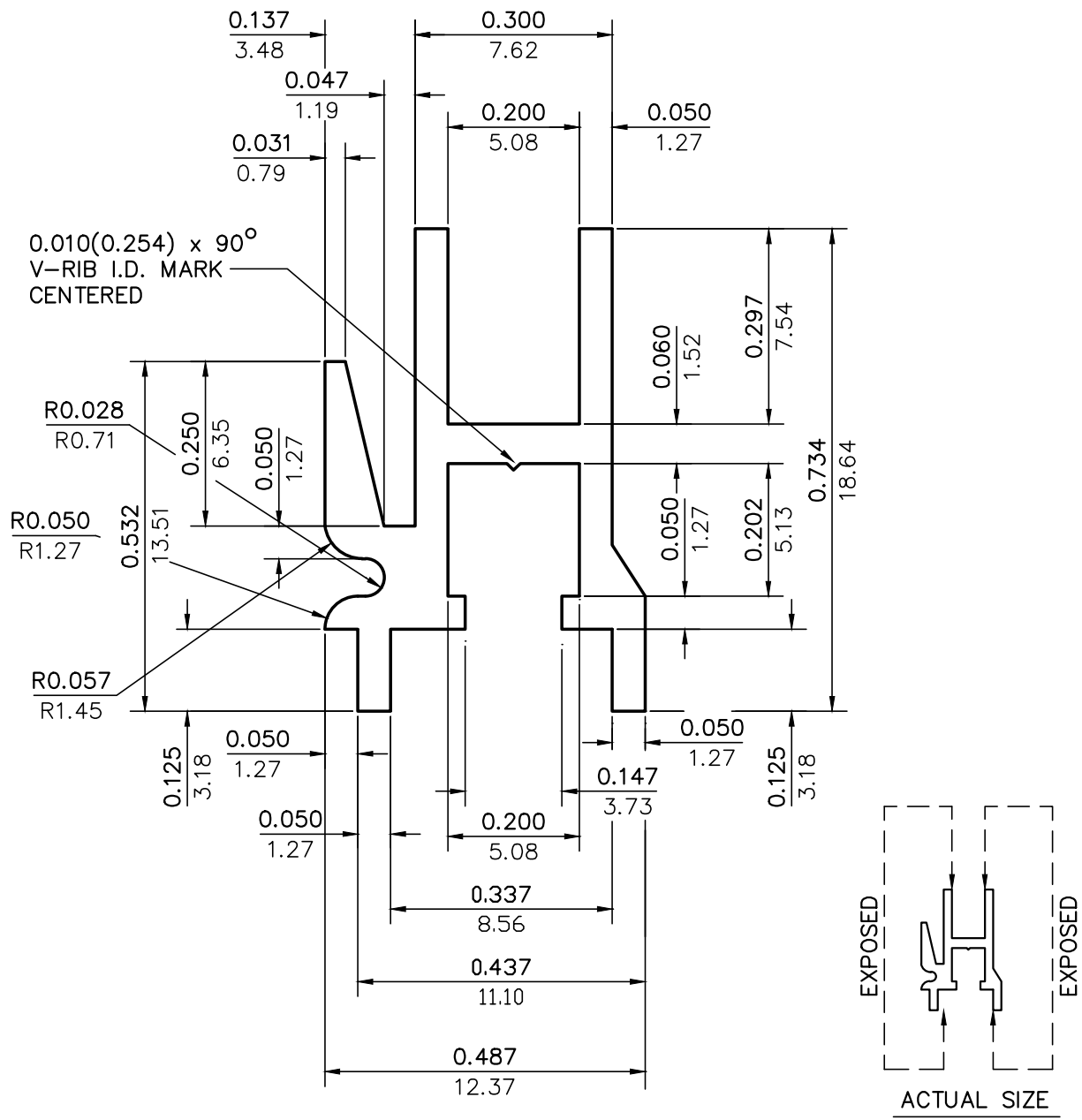

WALL THICKNESS 0.050 (1.27) EXCEPT AS SHOWN

DATE	REV	DESCRIPTION	BY		
05/31/99	1	REDRAWN	P.M.		
11/14/00	2	UPDATED DRAWING	P.M.		
EST.AREA	0.123	IN. <sup>2</sup>	EST.AREA 79.511	MM. <sup>2</sup>	
EST.WT.	0.145	LBS/FT.	EST.WT. 0.216	KG/M.	
EST.PER.	4.427	IN.	EST.PER. 112.441	MM.	
OUT PER.		IN.	OUT PER.	MM.	
C.C.D.	0.831	IN.	C.C.D. 21.111	MM.	
FACTOR	30	FINISH	PAINT	ALLOY & TEMP.	6063-T5
CKD BY		SCALE	4:1	DWN BY	C.P.
		DATE	07/09/93		

**CAN ART**  
ALUMINUM EXTRUSION INC.  
85 PARKSHORE DRIVE  
BRAMPTON, ONT L6T 5M1  
TEL. NO. (905) 791-1464  
FAX NO. (905) 791-9151  
E-MAIL: canart@canart.com

THIS DRAWING IS NOT NECESSARILY A COPY OF YOUR ORIGINAL. PLEASE APPROVE DIMENSIONS AND TOLERANCES INDICATED. CAN ART ASSUMES NO RESPONSIBILITY EITHER TECHNICAL OR LEGAL FOR HAVING THIS SHAPE MADE. THE CUSTOMER AGREES TO FULLY PROTECT CAN ART ALUMINUM FROM CLAIMS OF OTHERS RESULTING FROM THIS SHAPE.

SIGNED: \_\_\_\_\_ DATE: \_\_\_\_\_